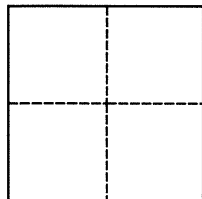

# CORNER RECORD

Agency Index 134 49Document Number CR 14115City of Berkeley (APN 62-2889-18) County of Alameda, CaliforniaBrief Legal Description Monument near 1817 Capistrano Avenue**CORNER TYPE****COORDINATES (Optional)**Government Corner ☐ Control ☒  
Meander ☐ Property ☐  
Rancho ☐ Other ☐

N. \_\_\_\_\_ E. \_\_\_\_\_

Elevation \_\_\_\_\_

Units Metric ☐ U.S. Survey Foot ☐

Horizontal Datum \_\_\_\_\_

Zone \_\_\_\_\_ Epoch Date \_\_\_\_\_

Date of Survey January 22, 2020

Vertical Datum \_\_\_\_\_

☐ Complies with Public Resources Code §§8801-8819☐ Complies with Public Resources Code §§8890-8902PLS Act Ref.: ☐ 8765(d) ☒ 8771 ☐ 8773 ☐ Other:Corner/  
Monument: ☒ Left as found ☐ Established ☐ Rebuilt ☒ Pre-Construction  
☐ Found and tagged ☐ Reestablished ☒ Referenced ☐ Post-Construction

Narrative of corner identified and monument as found, set, reset, replaced, or removed:

☒ See sheet #2 for description(s):

Found monument near 1817 Capistrano Avenue that could be damaged or destroyed by planned water line construction project. Monument was referenced as shown on page 2. The purpose of this Corner Record is to preserve possible evidence only; no attempt was made to determine the relationship to property, centerline, or right of way lines.

Reference EBMUD Field Book A, Page 96 (Taaning/Ingram)

**SURVEYOR'S STATEMENT**

This Corner Record was prepared by me or under my direction in conformance with

the Professional Land Surveyors' Act on April 16, 2020Signed [Signature] P.L.S. or R.C.E. No. 8889**COUNTY SURVEYOR'S STATEMENT**

This Corner Record was received

APR 17 2020

and examined and filed

APR 20 2020Signed D. Ian Wilson P.L.S. or R.C.E. No. 7010Title ALAMEDA COUNTY SURVEYOR

County Surveyor's Comment

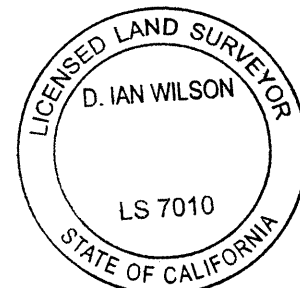

**BERKELEY****ALAMEDA COUNTY**THOUSAND  
OAKS TRACT

25 M 2

BLK 11

LOT 34

LOT 33

1817 CAPISTRANO AVE  
APN: 62-2889-18

[99.44']

25.2' E

FROM WM

[101.65']

4.7' W OF W EDGE OF DW  
TO 1821 CAPISTRANO**GT16A1**

[100.00']

18.36

[100.80']

16.6' E OF WM

CAPISTRANO AVE

[98.46']

14.9' E

OF WM

**LEGEND**FOUND 2" BRASS DISK W/ PUNCH IN CONCRETE POST, 0.6' BELOW  
STREET GRADE, UNDER STANDARD MONUMENT WELL, STAMPED "CITY  
OF BERKELEY UNLAWFUL TO DEFACE"SET CONCRETE NAIL AND 1-1/2" ALUMINUM WASHER STAMPED  
"EBMUD MON RP"**AA##A#**

ALAMEDA COUNTY MONUMENT ID

[ ]

ASSUMED ELEVATION (MEASURED USING A LEICA DNA10 DIGITAL  
LEVEL)

ADDRESS: 1817 CAPISTRANO AVENUE

APN: 62-2889-18

SCALE  
1"=20'