

BK 28 Pg 60

CORNER RECORD

Document Number CR 3179

City of OAKLAND

County of ALAMEDA, California

Brief Legal Description PARCEL 1 PM 7572 254 PM 26

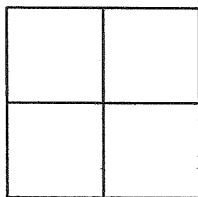

CORNER RECORD

Government Corner ☐ Control ☐
Meander ☐ Property ☒
Rancho ☐ Other ☐
Date of Survey 11/8/07

COORDINATES
(Optional)

N. _____
E. _____
Zone _____ Datum _____
Elev. _____

Corner — Left as found ☐ Found and tagged ☐ Established ☒ Reestablished ☐ Rebuilt ☐

Identification and type of corner found: Evidence used to identify or procedure used to establish of reestablish the corner:

FOUND STANDARD CITY MONUMENTS WITHIN YERBA BUENA AVENUE AS SHOWN ON

SHEET 2.

A description of the physical condition of the monument as found and as set or reset:

FOUND AND SET POINTS AS SHOWN ON PAGE 2.

SURVEYOR'S STATEMENT

This Corner Record was prepared by me or under my direction in conformance with the Land Surveyors' Act on NOVEMBER 20, 20 07.

Signed Vincent H. Cunha L.S. Number LS 4520
VINCENT H. CUNHA

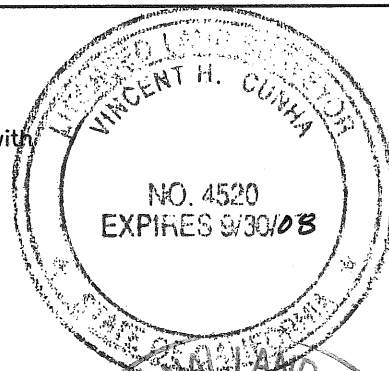

COUNTY SURVEYOR'S STATEMENT

This Corner Record was received _____ 20 _____ and examined

and filed 11-28-2008

Signed Russell R. Penland, Jr. Title County Surveyor

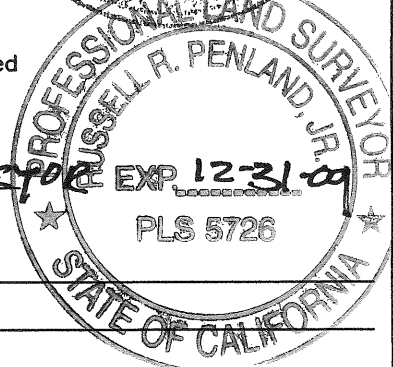

County Surveyor's Comment

