

# CORNER RECORD

BK 41 Pg 48

APN No. \_\_\_\_\_ (Optional) Document Number CR 4273  
 City of SAN LORENZO (unincorporated) County of ALAMEDA, California  
 Brief Legal Description MONUMENT REFERENCE AT THE INTERSECTION OF  
BOCKMAN ROAD AND BOXER COURT

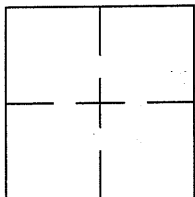

## CORNER TYPE

Government Corner ☐ Control ☒  
 Meander ☐ Property ☐  
 Rancho ☐ Other ☐  
 Date of Survey JULY 13, 2010

## COORDINATES

(Optional)

N. \_\_\_\_\_  
 E. \_\_\_\_\_  
 Zone \_\_\_\_\_ Datum \_\_\_\_\_  
 Elev. \_\_\_\_\_

Corner — Left as found ☒ Found and tagged ☐ Established ☐ Reestablished ☐ Rebuilt ☐

In compliance with Section 8771 of the Professional Land Surveyors' Act, this corner record is being filed to  
 ESTABLISH X / REESTABLISH \_\_\_\_\_ the position of an existing monument PRIOR X / SUBSEQUENT \_\_\_\_\_  
 to street or highway reconstruction. (Use this portion only when applicable.)

Identification and type of corner found: Evidence used to identify or procedure used to establish or reestablish the corner:  
VERIFIED EXISTING COUNTY MONUMENT YQ86J2 PRIOR TO AN UPCOMING PAVEMENT  
REHABILITATION PROJECT

A description of the physical condition of the monument as found and as set or reset: \_\_\_\_\_  
SET CUT CROSS ON BACK OF WALK

## SURVEYOR'S STATEMENT

This Corner Record was prepared by me or under my direction in conformance with  
 the Land Surveyors' Act on SEPTEMBER 28 2011

Signed [Signature] L.S. Number 6868

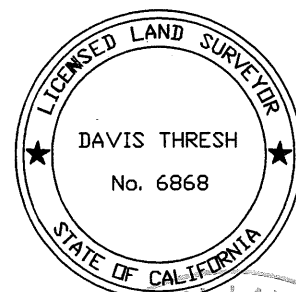

## COUNTY SURVEYOR'S STATEMENT

This Corner Record was received 8-10 20 10 and examined  
 and filed 10-2 20 11

Signed [Signature] Title: County Surveyor

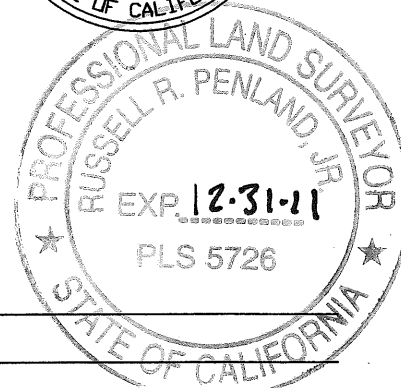

County Surveyor's Comment \_\_\_\_\_

YQ86J2

