

A:\320-0001\320-6101-0000\Draw\DWG Construction Documents\320610-0101-0000.dwg (C000) - 15/04/2022 - 2:43 PM

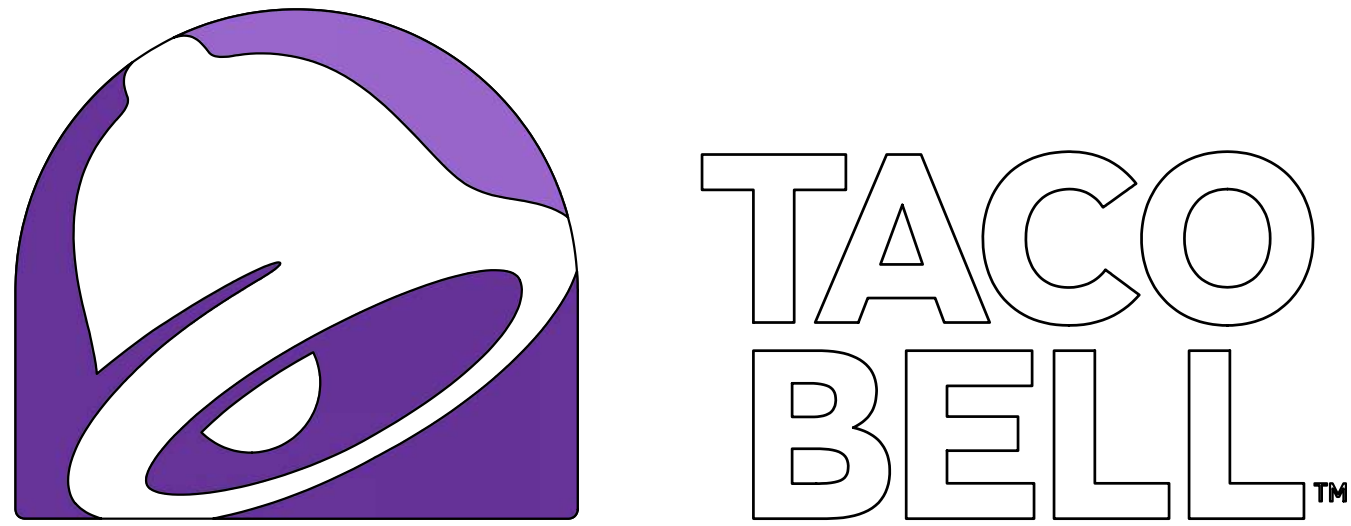

CIVIL CONSTRUCTION PLANS

567 SPEARS CREEK CHURCH ROAD

ELGIN, SC 29045

MAY 4, 2022

PROJECT TEAM:

OWNER
BELL CAROLINA, LLC.
6200 OAK TREE BOULEVARD
SUITE 250
INDEPENDENCE, OHIO 44131
PH: (317) 507-3881
CONTACT: T. ROBERT LACH

SURVEYOR
FREELAND & ASSOCIATES, INC.
323 WEST STONE AVE.
GREENVILLE, SC 29609
PH: (864) 271-4924
CONTACT: JAMES FREELAND
EMAIL: info@freeland-associates.com

CIVIL ENGINEER
CIVIL & ENVIRONMENTAL CONSULTANTS, INC.
11 MUNICIPAL DRIVE
SUITE 300
FISHERS, IN 46038
PH: (317) 570-8800
CONTACT: MICHAEL THOMPSON
EMAIL: mathompson@cecinc.com

UTILITY CONTACTS:

SANITARY SEWER SERVICE

PALMETTO UTILITIES
1710 WOODCREEK FARMS RD
ELGIN, SC 29045
CONTACT: ADAM DELK
PH: (803) 699-2422

STORM WATER FACILITIES

CITY OF COLUMBIA WATER
1136 WASHINGTON ST
COLUMBIA, SC 29201
CONTACT: MIRANDA STAPLES
PH: (803) 545-3400

WATER SERVICE

CITY OF COLUMBIA WATER
1136 WASHINGTON ST
COLUMBIA, SC 29201
CONTACT: CHRISTOPHER WILLIAMS
PH: (803) 545-4542

ELECTRIC SERVICE

DOMINION ENERGY SERVICES
520 FARMERS TELEPHONE ROAD
SUMTER, SC 29153
CONTACT: LEE GLAZE
PH: (803) 217-1150

GAS SERVICE

DOMINION ENERGY SERVICES
520 FARMERS TELEPHONE ROAD
SUMTER, SC 29153
CONTACT: LEE GLAZE
PH: (803) 217-1150

BENCHMARKS:

BEARINGS BASED ON OPUS SOLUTION # OP1638219401005 AND MONUMENT "RC085209". ELEVATIONS BASED ON OPUS SOLUTION # OP1638219401005.

NAD 83 - NAVD 88

TBM: RAILROAD SPIKE IN POWER POLE

ELEV. = 356.46

TBM: MAG NAIL

ELEV. = 352.37

REFERENCE:

EXISTING INFORMATION BASED ON SURVEY PROVIDED BY FREELAND & ASSOCIATES, INC., 323 WEST STONE AVE., GREENVILLE, SC 29609, 864-271-4924, DWG NO: 76095, DATED 12/06/2021.

THIS INFORMATION IS SPECULATIVE IN NATURE ONLY AND SHOULD NOT BE CONSTRUED AS FACT. CEC, INC. DOES NOT WARRANT ANY OF THE EXISTING INFORMATION SHOWN. PRIOR TO ANY EXCAVATION FOR UNDERGROUND UTILITIES, CONTRACTOR SHALL EXPOSE AND VERIFY LOCATIONS (HORIZONTAL AND VERTICAL) OF ALL EXISTING UTILITIES INCLUDING BUT NOT LIMITED TO GAS, WATER, STORM SEWER AND SANITARY SEWER, FORCE MAIN, ELECTRIC, TELECOM. ANY CONFLICTS THAT OCCUR DURING CONSTRUCTION SHOULD BE IMMEDIATELY BROUGHT TO THE ATTENTION OF THE ENGINEER AND OWNER.

UTILITY NOTE:

THE UNDERGROUND UTILITIES SHOWN HAVE BEEN LOCATED FROM FIELD SURVEY INFORMATION AND EXISTING DRAWINGS. THE SURVEYOR MAKES NO GUARANTEES THAT THE UNDERGROUND UTILITIES COMPRISE ALL SUCH UTILITIES IN THE AREA, EITHER IN-SERVICE OR ABANDONED. THE SURVEYOR FURTHER DOES NOT WARRANT THAT THE UNDERGROUND UTILITIES SHOWN ARE IN THE EXACT LOCATION INDICATED ALTHOUGH THE SURVEYOR DOES CERTIFY THAT THEY ARE LOCATED AS ACCURATELY AS POSSIBLE FROM INFORMATION AVAILABLE. THE SURVEYOR HAS NOT PHYSICALLY LOCATED THE UNDERGROUND UTILITIES.

PRIOR TO ANY EXCAVATION FOR UNDERGROUND UTILITIES, CONTRACTOR SHALL EXPOSE AND VERIFY LOCATIONS (HORIZONTAL AND VERTICAL) OF ALL EXISTING UTILITIES INCLUDING BUT NOT LIMITED TO GAS, WATER, AND SANITARY SEWER. ANY CONFLICTS SHALL BE REPORTED IMMEDIATELY TO THE ENGINEER AND THE APPROPRIATE AUTHORITIES.

FLOOD NOTE:

THE PARCEL DESCRIBED AND SHOWN HEREIN LIES WITHIN ZONE "X" (UNSHADED) AS SAID PARCEL PLOTS ON MAP NUMBER 45079 C 0277 L (DATED DECEMBER 21, 2017) OF THE FLOOD INSURANCE RATE MAPS FOR THE TOWN OF ELGIN, KERSHAW COUNTY, SOUTH CAROLINA. THE ACCURACY OF THIS FLOOD HAZARD STATEMENT IS SUBJECT TO MAP SCALE UNCERTAINTY AND TO ANY OTHER UNCERTAINTY IN LOCATION OR ELEVATION ON THE REFERENCED FLOOD INSURANCE RATE MAP.

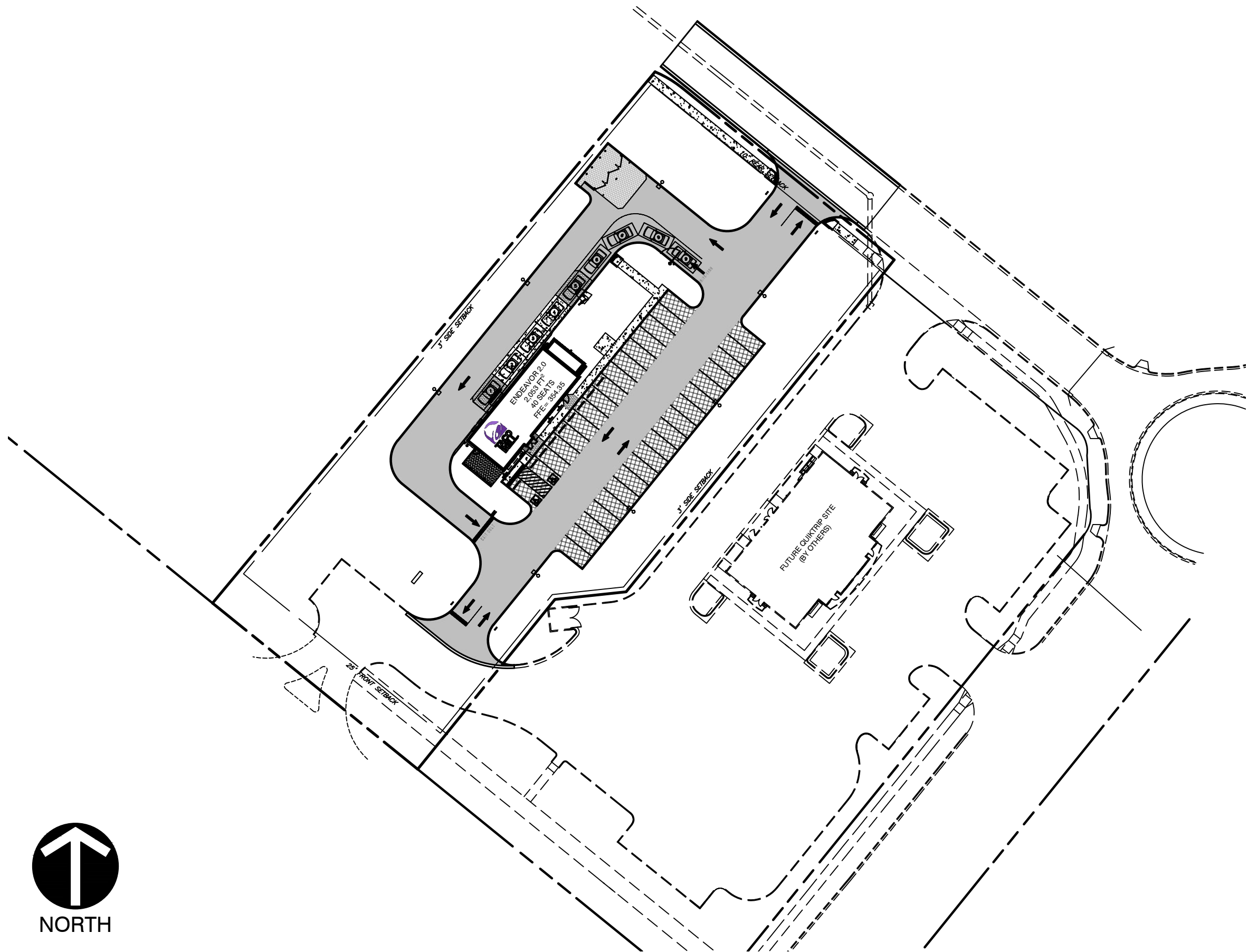

SITE MAP

SCALE: 1"=60'

SCALE IN FEET

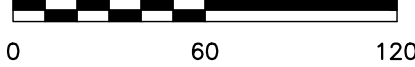

VICINITY MAP

BASE IMAGE FROM GOOGLE EARTH

ACCESSED APR. 2022

SCALE: 1"=1,000'

SCALE IN FEET

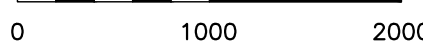

PLAN INVENTORY

STORM SEWER

SIZE	LENGTH
10" PVC	143 LF
12" RCP	370 LF
15" RCP	79 LF

PAVEMENT

MATERIAL	AREA
STANDARD DUTY	6,442 FT²
HEAVY DUTY	17,630 FT²
BLACK CONCRETE	1,282 FT²
CONCRETE	945 FT²

CURB

TYPE	LENGTH
6" CURB	1,050 FT
CURB AND WALK	173 FT
CURB AND GUTTER	242 FT
DEPRESSED GUTTER	142 FT

TITLE SHEET

DATE: 05/19/2022
DRAWN BY: KRG
DRAFT
AS NOTED (CHECKED BY: 320-610)
PROJECT NO: 320-610
APPROVED BY: DRAFT

DRAWING NO.:

C000

SHEET 01 OF 19



Know what's below.
Call before you dig.

PRELIMINARY
BID SET

SUBMITTAL & REVISION RECORD

DESCRIPTION

NO. DATE

Civil & Environmental Consultants, Inc.
11 Municipal Drive - Suite 300 - Fishers, IN 46038
Ph: 317.655.7777 - 877.746.0749 - Fax: 317.655.7778
www.cecinc.com

BELL CAROLINA, LLC.
TACO BELL
567 SPEARS CREEK CHURCH ROAD
ELGIN, SC 29045